

**This electronic collection of documents is provided  
for the convenience of the user  
and is Not a Certified Document –**

**The documents contained herein were originally issued  
and sealed by the individuals whose names and license  
numbers appear on each page, on the dates appearing  
with their signature on that page.**

**This file or an individual page  
shall not be considered a certified document.**

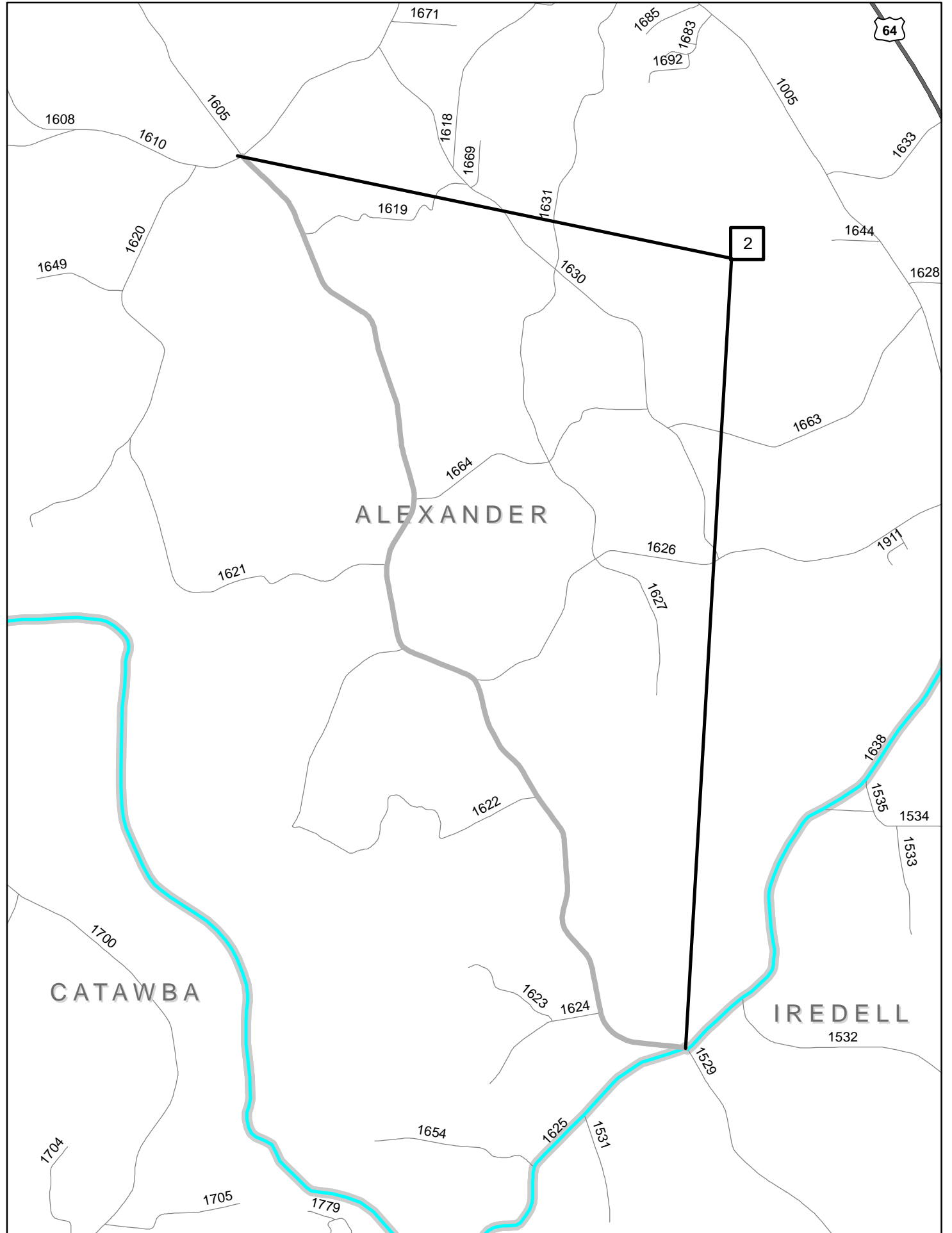

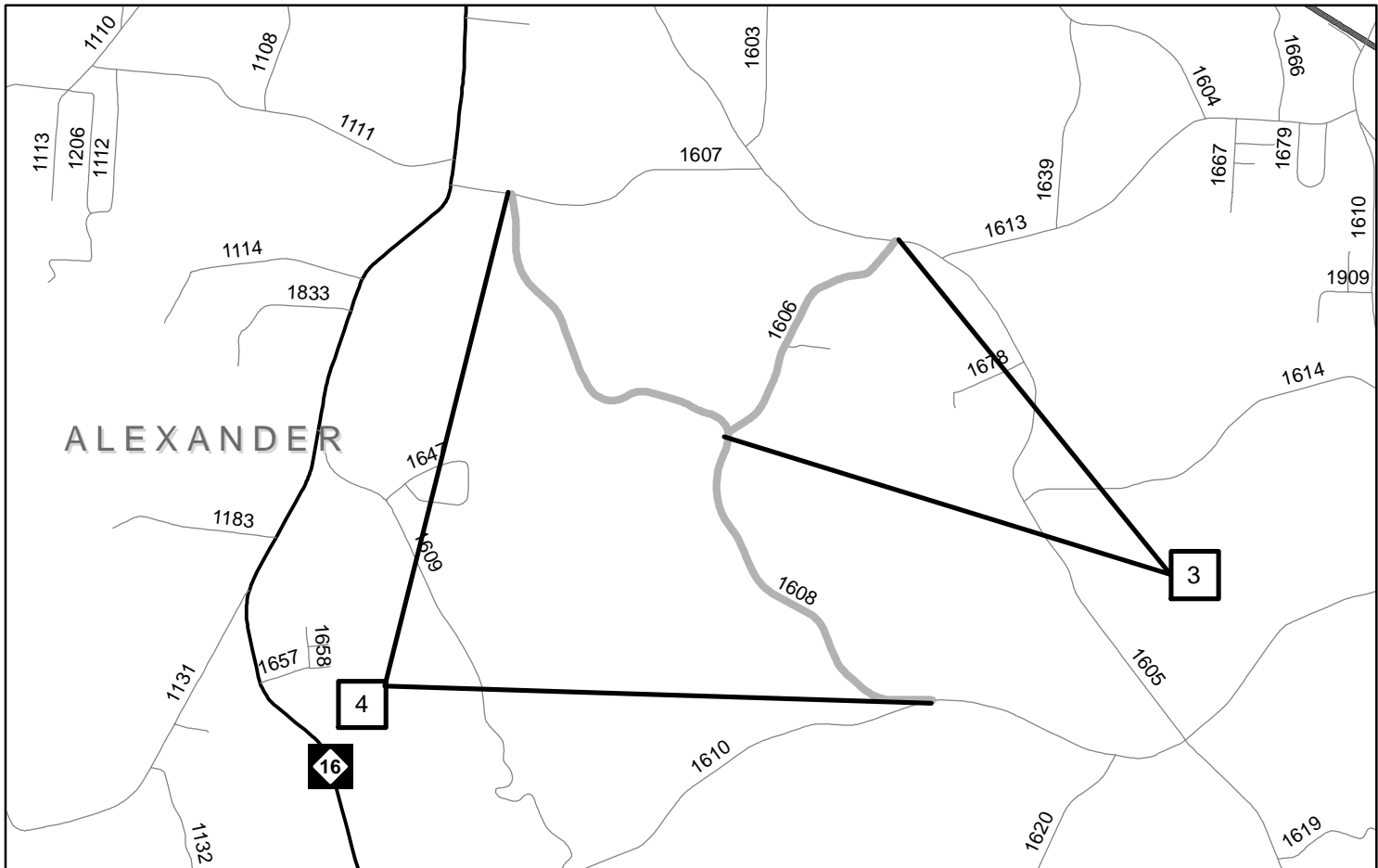
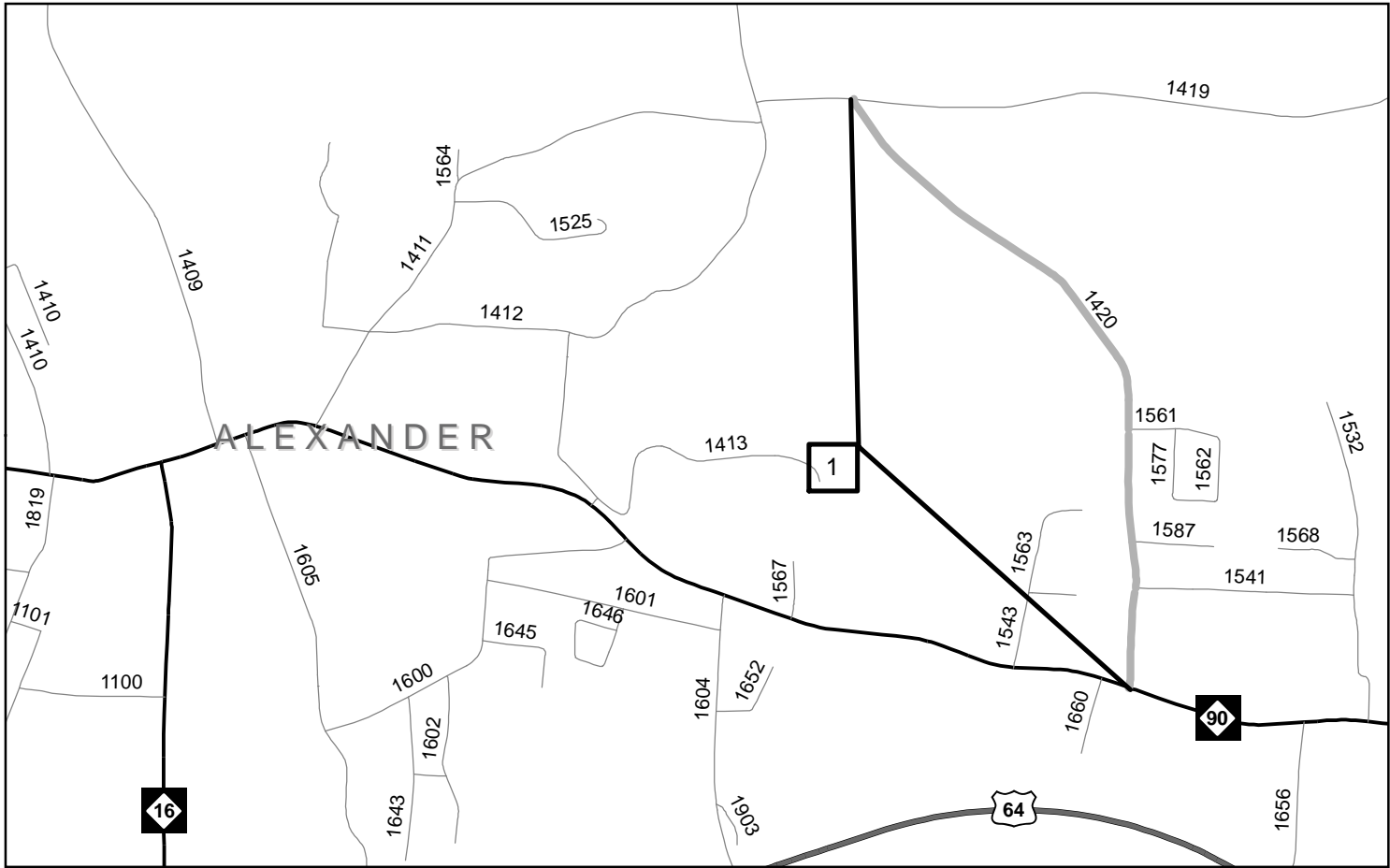
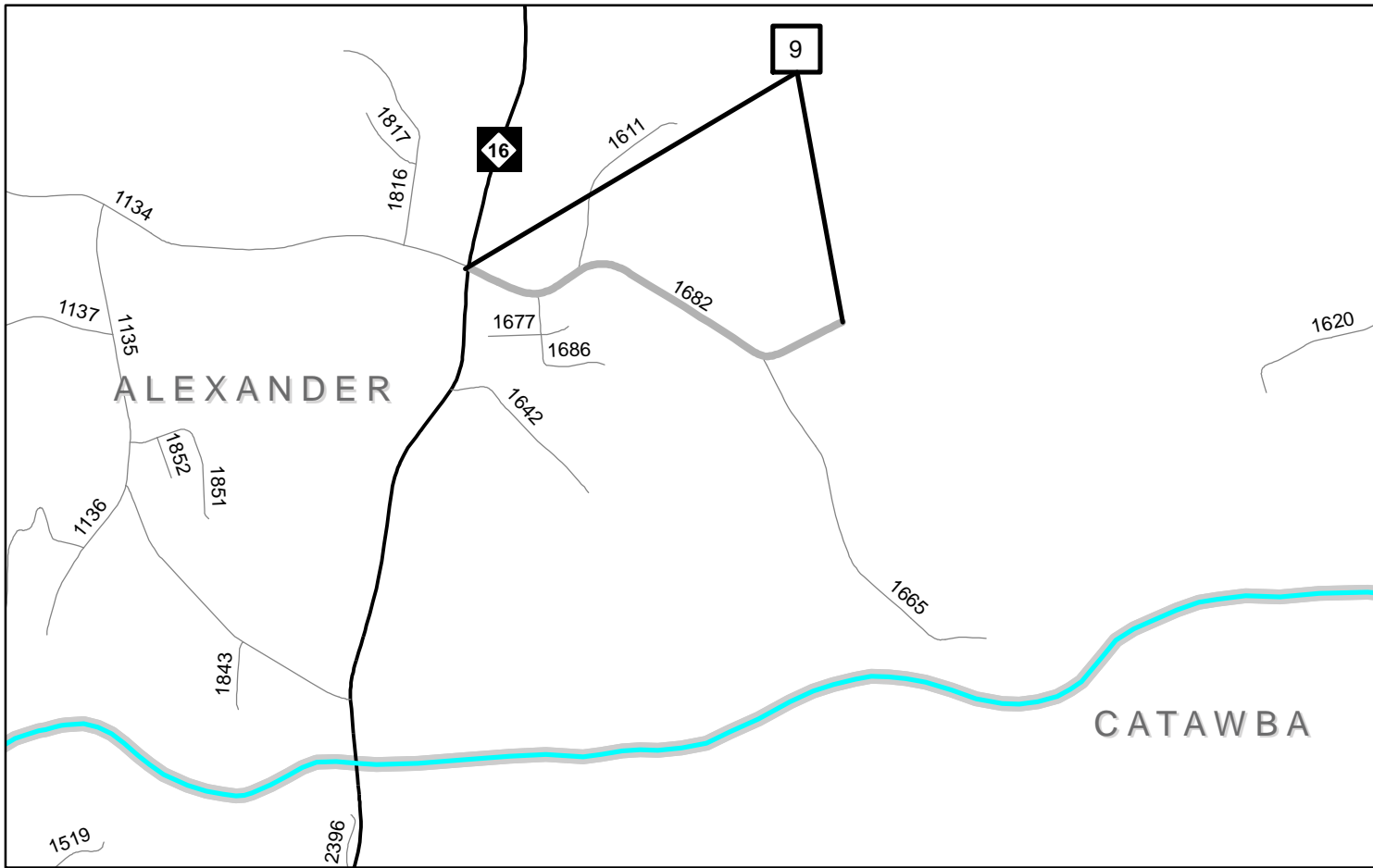
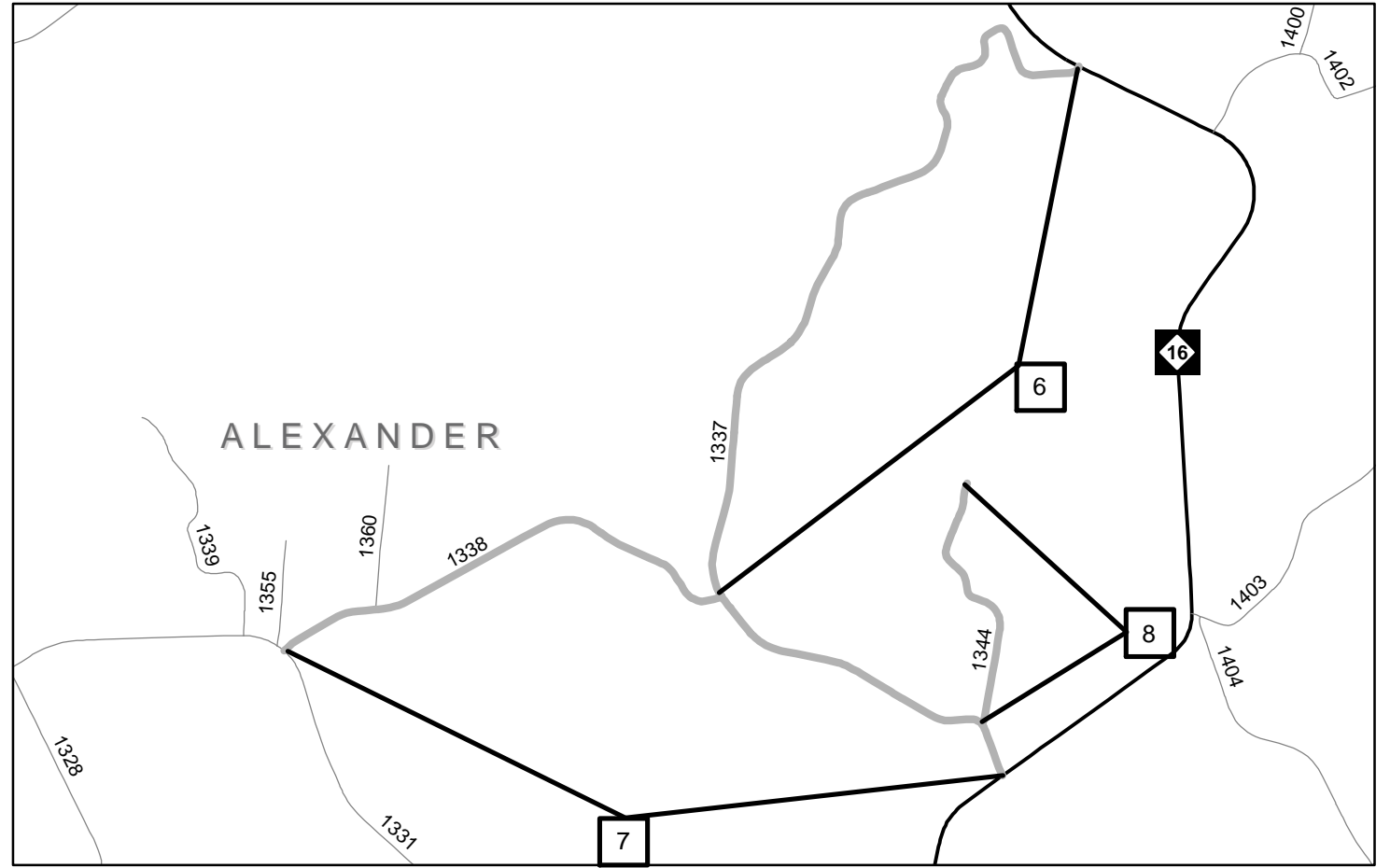
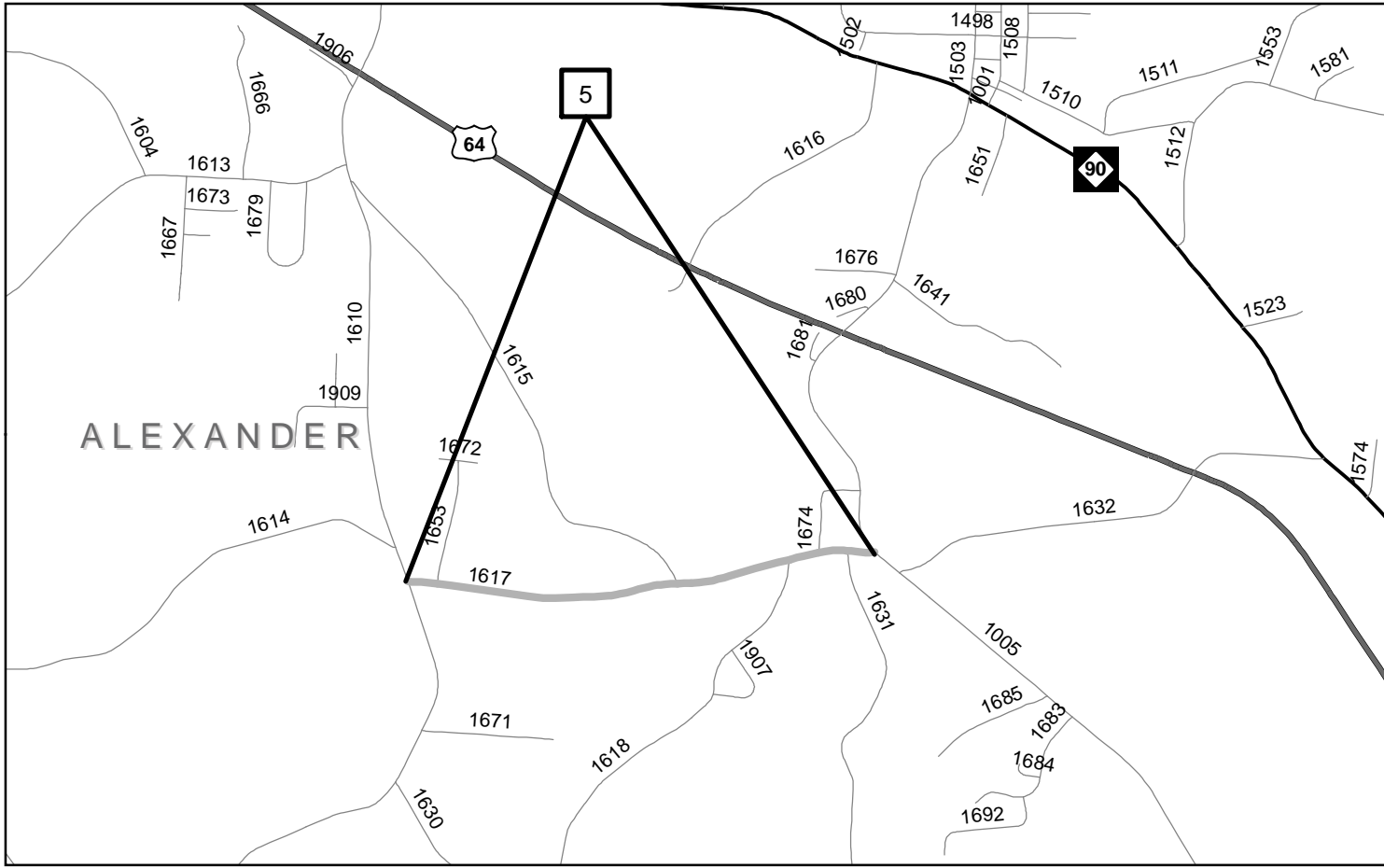

PAVEMENT SCHEDULE	
F	ASPHALT SURFACE TREATMENT, DOUBLE SEAL, USING A TOP LAYER OF LIGHTWEIGHT AGGREGATE AND A BOTTOM LAYER OF #78M AGGREGATE
G	ASPHALT SURFACE TREATMENT, FOG SEAL USING A TARGET APPLICATION RATE OF 0.12 GAL/SY, +/- 0.03 GAL/SY

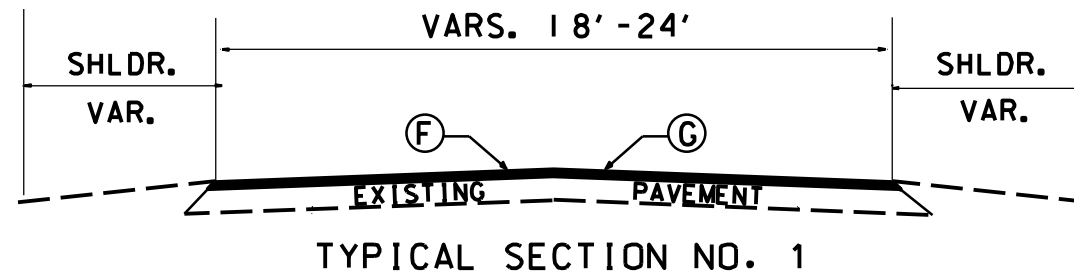

2020-2021  
 PVMT. PRESERVATION  
 ALEXANDER COUNTY

PROJECT NO.	SHEET NO.	TOTAL NO.
2020CPT.12.09.20022	5	7

## SUMMARY OF QUANTITIES

PROJECT NO	COUNTY	MAP NO	ROUTE	DESCRIPTION	TYP NO	LANES	LANE TYPE	FINAL SURFACE TESTING REQUIRED	LENGTH		WIDTH		1803500000-E	1820000000-E	1838000000-E	2143000000-E
									MI	FT	ASPHALT SURFACE TREATMENT, DOUBLE SEAL SY	ASPHALT SURFACE TREATMENT, FOG SEAL SY	EMULSION FOR ASPHALT SURFACE TREATMENT GAL	BLOTTING SAND TON		
2020CPT.12.09.20022	Alexander	1	SR 1420 (LEWITTES RD.)	FROM SR 1419 (ROCKY SPRINGS RD.) TO NC 90	1	2	2WU	NO	1.37	22			19,450	19,450	10,115	10
2020CPT.12.09.20022	Alexander	2	SR 1605 (PAUL PAYNE STORE RD.)	FROM IREDELL COUNTY LINE TO SR 1610 (MILLERSVILLE RD.)	1	2	2WU	NO	5.9	20			76,150	76,150	39,598	45
2020CPT.12.09.20022	Alexander	3	SR 1606 (CROUCH RD.)	FROM SR 1605 (PAUL PAYNE STORE RD.) TO SR 1608 (OLD LANDFILL RD.)	1	2	2WU	NO	0.95	19			11,650	11,650	6,058	10
2020CPT.12.09.20022	Alexander	4	SR 1608 (OLD LANDFILL RD.)	FROM SR 1607 (MACEDONIA CHURCH RD.) TO SR 1610 (MILLERSVILLE RD.)	1	2	2WU	NO	2.7	22			38,350	38,350	19,942	20
2020CPT.12.09.20022	Alexander	5	SR 1617 (LIBERTY CHURCH RD.)	FROM SR 1610 (MILLERSVILLE RD.) TO SR 1005 (OLD MTN. RD.)	1	2	2WU	NO	1.23	24			19,050	19,050	9,907	10
2020CPT.12.09.20022	Alexander	6	SR 1337 (SILAS DEAL RD.)	FROM NC 16 TO SR 1338 (ST. CLAIR RD.)	1	2	2WU	NO	1.79	20			23,125	23,125	12,025	15
2020CPT.12.09.20022	Alexander	7	SR 1338 (ST. CLAIR RD.)	FROM NC 16 TO SR 1331 (LITTLE RIVER CHURCH RD.)	1	2	2WU	NO	1.89	19			23,150	23,150	12,038	15
2020CPT.12.09.20022	Alexander	8	SR 1344 (GASTON DEAL LN.)	FROM SR 1338 (ST. CLAIR RD.) TO DEAD END	1	2	2WU	NO	0.59	20			7,615	7,615	3,960	5
2020CPT.12.09.20022	Alexander	9	SR 1682 (WITTENBURG RD.)	FROM PVMT. CHANGE 175' E. OF NC 16 TO DEAD END	1	2	2WU	NO	1.03	18			11,975	11,975	6,227	10
<b>TOTAL FOR PROJ NO. 2020CPT.12.09.20022</b>									<b>17.45</b>				<b>230,515</b>	<b>230,515</b>	<b>119,870</b>	<b>140</b>
<b>GRAND TOTAL</b>									<b>17.45</b>				<b>230,515</b>	<b>230,515</b>	<b>119,870</b>	<b>140</b>

PROJECT NO.	SHEET NO.	TOTAL NO.
2020CPT.12.09.20022	6	7

## THERMOPLASTIC AND PAINT QUANTITIES

PROJECT NO	COUNTY	MAP NO	ROUTE	DESCRIPTION	TYP NO	LANES	LANE TYPE	LENGTH	WIDTH	4400000000-E	4457000000-N	4810000000-E	4810000000-E	
										WORK ZONE ADVANCE/GENERAL WARNING SIGNING	TEMPORARY TRAFFIC CONTROL	4" WHITE PAINT	4" YELLOW PAINT	
										MI	FT	SF	LS	LF
2020CPT.12.09.20022	Alexander	1	SR 1420 (LEWITTES RD.)	FROM SR 1419 (ROCKY SPRINGS RD.) TO NC 90	1	2	2WU	1.37	22	155		29,500	29,500	
2020CPT.12.09.20022	Alexander	2	SR 1605 (PAUL PAYNE STORE RD.)	FROM IREDELL COUNTY LINE TO SR 1610 (MILLERSVILLE RD.)	1	2	2WU	5.9	20	660		127,000	127,000	
2020CPT.12.09.20022	Alexander	3	SR 1606 (CROUCH RD.)	FROM SR 1605 (PAUL PAYNE STORE RD.) TO SR 1608 (OLD LANDFILL RD.)	1	2	2WU	0.95	19	115		20,500	20,500	
2020CPT.12.09.20022	Alexander	4	SR 1608 (OLD LANDFILL RD.)	FROM SR 1607 (MACEDONIA CHURCH RD.) TO SR 1610 (MILLERSVILLE RD.)	1	2	2WU	2.7	22	300		58,250	58,250	
2020CPT.12.09.20022	Alexander	5	SR 1617 (LIBERTY CHURCH RD.)	FROM SR 1610 (MILLERSVILLE RD.) TO SR 1005 (OLD MTN. RD.)	1	2	2WU	1.23	24	140		26,500	26,500	
2020CPT.12.09.20022	Alexander	6	SR 1337 (SILAS DEAL RD.)	FROM NC 16 TO SR 1338 (ST. CLAIR RD.)	1	2	2WU	1.79	20	200		38,550	38,550	
2020CPT.12.09.20022	Alexander	7	SR 1338 (ST. CLAIR RD.)	FROM NC 16 TO SR 1331 (LITTLE RIVER CHURCH RD.)	1	2	2WU	1.89	19	200		40,750	40,750	
2020CPT.12.09.20022	Alexander	8	SR 1344 (GASTON DEAL LN.)	FROM SR 1338 (ST. CLAIR RD.) TO DEAD END	1	2	2WU	0.59	20	75		12,700	12,700	
2020CPT.12.09.20022	Alexander	9	SR 1682 (WITTENBURG RD.)	FROM PVMT. CHANGE 175' E. OF NC 16 TO DEAD END	1	2	2WU	1.03	18	115		22,250	22,250	
<b>TOTAL FOR PROJ NO. 2020CPT.12.09.20022</b>										<b>17.45</b>	<b>1,960</b>	<b>1</b>	<b>376,000</b>	<b>376,000</b>
<b>GRAND TOTAL</b>										<b>17.45</b>	<b>1,960</b>	<b>1</b>	<b>376,000</b>	<b>376,000</b>

# SIGNING FOR ASPHALT SURFACE TREATMENT

**LEGEND**

- ◻ PORTABLE SIGN
- └ STATIONARY SIGN
- ← DIRECTION OF TRAFFIC FLOW

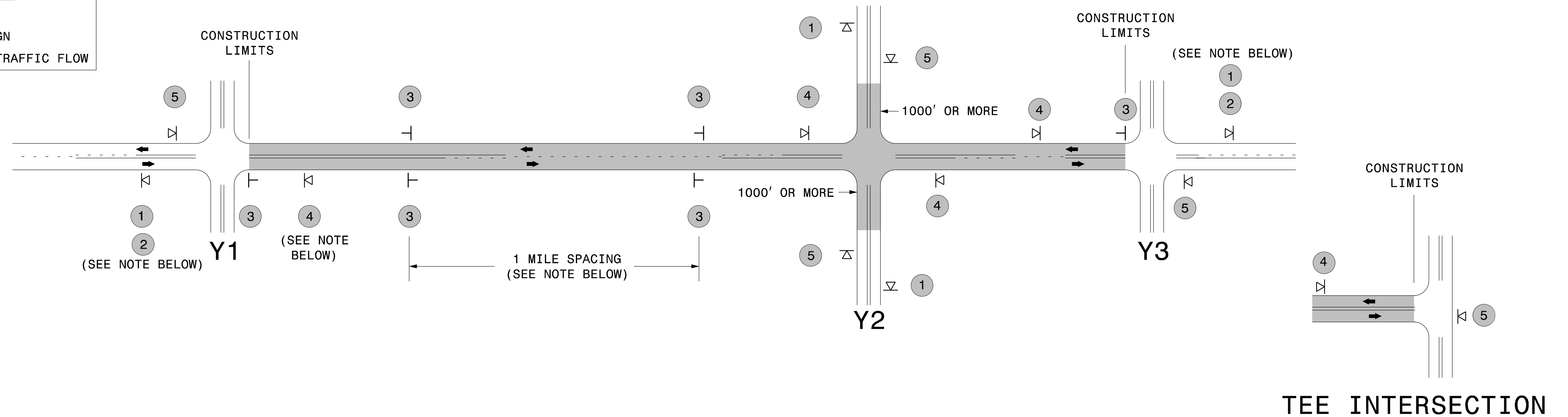

## MAINLINE (-L-) SIGNING

## -Y- LINE SIGNING

SIGNING NOTES AND PLACEMENT PER DIRECTION	1	 	<ul style="list-style-type: none"> <li>- PLACE 1000' PRIOR TO BEGINNING OF CONSTRUCTION LIMITS. ONLY USED ON -Y- LINES IF RESURFACING LIMITS EXTEND 1000' ALONG -Y- LINE.</li> <li>- SIGN #2 ONLY USED WHEN RESURFACING LIMITS ARE 2 OR MORE MILES IN LENGTH. ROUND UP TO THE NEAREST WHOLE NUMBER. DO NOT USE FRACTIONAL OR DECIMAL NUMBERS.</li> </ul>	<p>STATIONARY SIGNING NOT REQUIRED FOR THE FOLLOWING -Y- LINE CONDITIONS:</p> <ol style="list-style-type: none"> <li>1) LESS THAN 1000' OF RESURFACING ALONG -Y- LINE</li> <li>2) SUBDIVISION ROADS</li> <li>3) DEAD END ROADS</li> </ol> <p>WHEN PAVING/CONSTRUCTION ACTIVITIES PROCEED ACROSS AN UNSIGNED -Y- LINE, PORTABLE ADVANCE WARNING SIGNS SHALL BE USED ALONG THE -Y- LINE AS SHOWN BELOW. REMOVE UPON COMPLETION OF WORK.</p> <div style="display: flex; justify-content: space-around;"> <div style="text-align: center;">               PLACED 500' IN ADVANCE OF FLAGGER.         </div> <div style="text-align: center;">               PLACED 250' IN ADVANCE OF FLAGGER.         </div> </div>
	3	 	<ul style="list-style-type: none"> <li>- ALTERNATE THE FOLLOWING TWO SIGNS:</li> <li>- STARTING WITH "LOOSE GRAVEL" (W8-7) FOLLOWED BY "UNMARKED PAVEMENT".</li> <li>- PLACE INITIALLY AT THE CONSTRUCTION LIMITS AND SPACED 1 MILE APART THEREAFTER.</li> <li>- AT TEE INTERSECTIONS INSTALL INITIALLY 0.5 MILE FROM INTERSECTION AND SPACE 1 MILE APART THEREAFTER.</li> </ul>	
	4		<ul style="list-style-type: none"> <li>- THESE ARE FOR -Y- LINES THAT ARE "THROUGH" ROADWAYS. DEAD END AND SUBDIVISION ROADS ARE NOT "THROUGH" ROADWAYS.</li> <li>- INSTALL 500' +/- FROM EACH -Y- LINE APPROACH AS SHOWN ABOVE.</li> <li>- FOR MULTIPLE -Y- LINES THAT ARE SEPARATED BY 0.25 MILES OR LESS, TREAT AS A SINGLE UNIT AND INSTALL WITHIN 500' OF EACH APPROACH.</li> <li>- A MAXIMUM OF 2 SIGN SETS PER MILE. DO NOT INSTALL WHEN -Y- LINES ARE WITHIN 0.5 MILES FROM "END ROAD WORK" SIGN.</li> </ul>	
	5		<ul style="list-style-type: none"> <li>- PLACE 500' FOLLOWING THE END OF CONSTRUCTION LIMITS OR AS SHOWN WHEN WORK ENDS AT A 3-WAY TEE INTERSECTION.</li> </ul>	
	<p>THE ABOVE SIGNS ARE ALL THAT ARE REQUIRED FOR A CONTRACTOR TO BEGIN A RESURFACING CONTRACT. ANY ADDITIONAL SIGNS REQUESTED BY NCDOT DIVISIONS SHALL BE INSTALLED WITHIN 7 BUSINESS DAYS OF THE START OF CONTRACT WORK.</p>			

**MAPS LESS THAN 2 MILES**

FOR AST RESURFACING MAPS WITH CONSTRUCTION LIMITS LESS THAN 2 MILES IN LENGTH, USE A STATIONARY "LOOSE GRAVEL" SIGN AT THE BEGINNING CONSTRUCTION LIMIT FOLLOWED BY AN "UNMARKED PAVEMENT" SIGN MIDWAY THROUGH AND AN "END ROAD WORK" SIGN AT THE END CONSTRUCTION LIMIT.

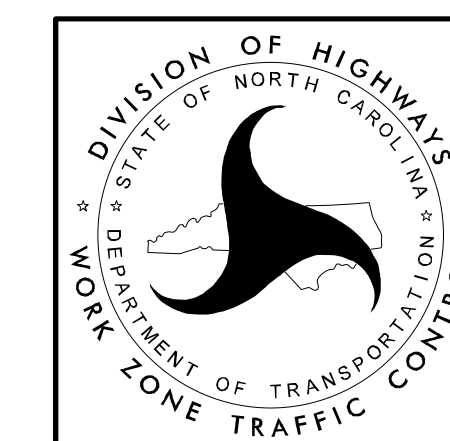

**ADVANCE WARNING SIGNS FOR 2-LANE ROADWAY ASPHALT SURFACE TREATMENT**